

CALIBRE™

RADAR AND LASER PROTECTION

INSTALLATION INSTRUCTIONS & RECOMMENDED PROCEDURES

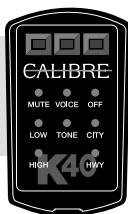

The included **CALIBRE Remote Control** is used to allow the driver to adjust settings on the **CALIBRE** and to mute audio alerts during prolonged encounters. It may be mounted virtually anywhere inside the vehicle with the included double stick tape or remain unmounted.

WARNING LED(S)

(MODELS: CALIBRE **DL/SL**)

1. Consult with vehicle owner about LED location. For best visibility, choose a mounting location as close to the vehicle gauges as possible.
2. Check for proper clearance behind the area where the LED(s) will be installed (approximately 1") and drill a 3/16" hole in the chosen location for the LED(s). CALIBRE **DL** models require the mounting of a second LED for rear radar warnings.
3. Route all of the LED wires under the dash per DIAGRAM A1.

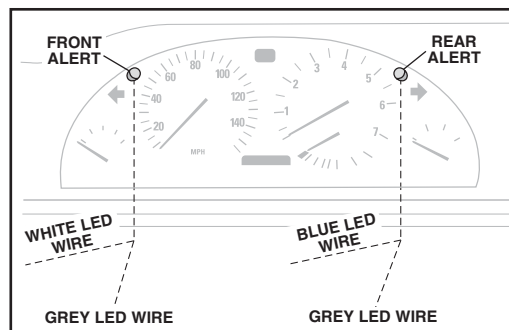

DIAGRAM A1

WARNING POD(S)

(MODELS: CALIBRE **DL-P/SL-P**)

1. Consult with vehicle owner about Pod location. For best visibility, choose a mounting location as close to the vehicle gauges as possible.
2. Before mounting the Warning Pod(s), clean both the Pod surface and desired mounting location on the dash with isopropyl alcohol.
3. Position the Warning Pod(s) on the dash with the provided double stick "O" ring tape. CALIBRE **DL-P** models require the mounting of a second Pod for rear radar warnings.
4. Route the black cable(s) from the Warning Pod(s) through or under the dash per DIAGRAM B1.

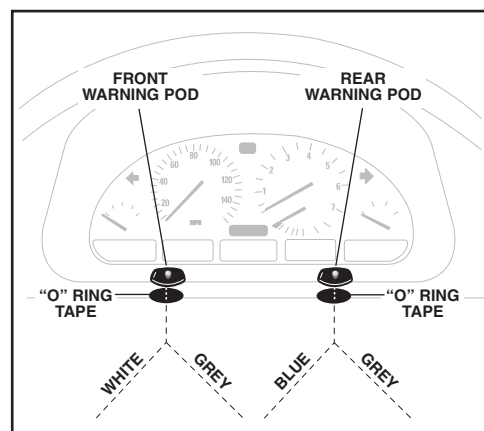
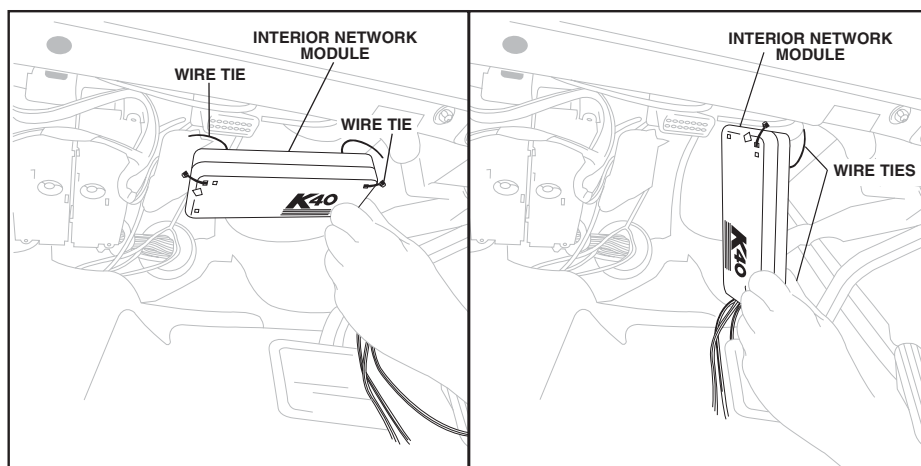

DIAGRAM B1

INTERIOR NETWORK MODULE

1. Remove the under dash panel and mount the Interior Network Module using the supplied cable ties to the existing factory wire looms, brackets, or other support structures as per DIAGRAM C1. The Interior Network Module can be mounted horizontally or vertically under the dash.
2. Connect the LED, ignition, and ground wires per the separate enclosed block diagram sheet.



HORIZONTAL MOUNT

DIAGRAM C1

VERTICAL MOUNT

AMPLIFIED SPEAKER

1. Route the amplified speaker cable around a panel edge and reattach the under dash panel per DIAGRAM D1.
2. For maximum audio output and concealment, mount the amplified speaker to the outside of the under dash panel with the supplied screws per DIAGRAM D1.

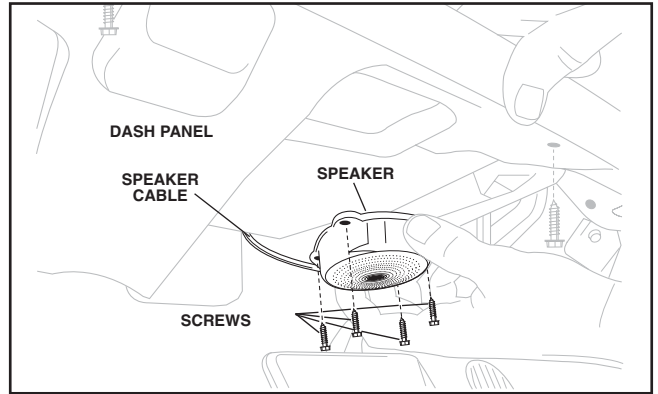

DIAGRAM D1

NOTE: *If the vehicle is not equipped with an under dash panel (e.g., Porsche), mount the amplified speaker to existing factory wire looms, brackets, or support structures with the supplied cable ties.*

FRONT RADAR RECEIVER

1. Choose a mounting location in the front of the vehicle per DIAGRAM E1. The radar receiver can be mounted horizontally or vertically provided the arrows are pointing forward, towards the road ahead.
2. Mount the front radar receiver with the supplied screws or wire ties to the vehicle's structure per DIAGRAM E1.
3. Route the wires to the desired connection point and connect per the separate enclosed block diagram sheet.

NOTE: *All radar receivers can be mounted behind plastic, rubber, or fiberglass up to 1/4" thick. Do not mount radar receiver behind metal, carbon fiber or chromed plastic.*

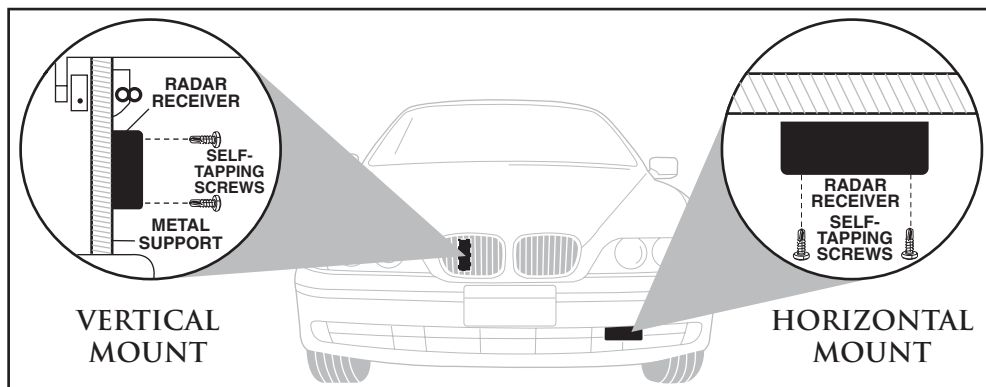

DIAGRAM E1

REAR RADAR RECEIVER

1. The rear radar receiver can be fastened to the vehicle using the supplied self-tapping screws or cable ties. See DIAGRAM F1.
2. Route the rear radar receiver cable into trunk through factory grommet.
3. If a factory grommet is not available, use the provided strain relief:
 - a. Choose a location in the trunk compartment as close to the radar receiver as possible.
 - b. Drill a 1/2" hole into the chosen location for the strain relief.
 - c. Install the strain relief and tighten the mounting nut securely.
 - d. Route the rear radar receiver cable through the strain relief, leaving a little slack in the receiver cable.
 - e. Tighten the waterproof gasket nut to create a waterproof seal.
4. Connect wires per the separate enclosed block diagram sheet.

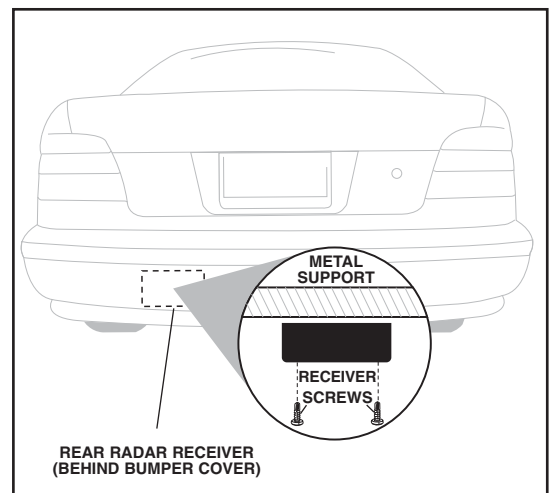

DIAGRAM F1

CRITICAL

NOTES FOR CALIBRE INSTALLATION

1. The Calibre radar receivers are interchangeable. It's the wire color code that differentiates between front or rear radar. When you cut the cables to length, remember that the **White** wire is battery power for the front receiver and the **Blue** wire is battery power for the rear receiver. If the same color is used for both the front and the rear receivers only one receiver will be recognized.
2. Calibre radar receiver cables and EX Defuser cables should be cut to length. If the additional wire is "balled up" it can act as an "RF" choke and cause operational anomalies.
3. Calibre radar receiver cables and EX Defuser cables are color-coded the same. The connections are **Brown to Brown, Yellow to Yellow, and Black to Black to Ground.**
4. The ground wires on the Interior Network Module and the radar receivers should be connected to an independent ground and not connected to a factory ground wire or lug.
5. The radar receivers and the Interior Network Module should never have their power wires or ground wires connected to each other or to the same power or ground point.
6. The Interior Network Module must be connected to an isolated source of +12 Volt Ignition-on and should not be connected in parallel with any other aftermarket accessory. Use of a factory wire of less than 16ga requires an Ignition control relay.
7. The radar receivers should be connected to +12 volt battery power. A +12 volt Ignition-on source is an option if battery power is not available.
8. Do not reset the Calibre system components when doing a new installation or a re-installation of original components. A reset should **only** be done when a radar receiver or Interior Network Module has been replaced. Replacement of a handheld remote or the addition of an EX Defuser does not require that a reset be done.
9. Do not use any fuse larger than 1 amp for any components.
10. Use only Duracell AAAA batteries for replacement in the handheld remote control. Use of any other brand batteries may result in erratic operation. Common signs that the batteries need to be replaced are intermittent communication between the handheld remote control and the Interior Network Module and pulsing or flashing remote control LED's after a button press.

Any questions please call: 800.323.6768 24hr. Technical Support: 800.759.7243
Enter 55880 Press # and follow directions.

CALIBRE
RADAR AND LASER PROTECTION

K40
ELECTRONICS™